

IP66

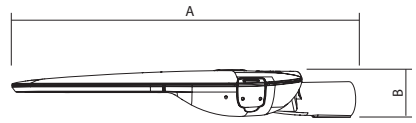

220-240V  
50/60Hz

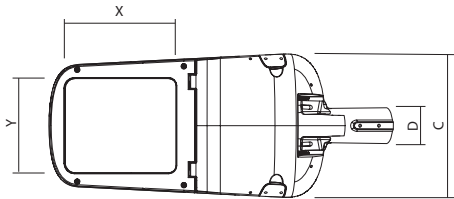

|            | A   | B   | C   | D  | X   | Y   |
|------------|-----|-----|-----|----|-----|-----|
| ESTA LED S | 630 | 95  | 265 | 60 | 185 | 150 |
| ESTA LED M | 720 | 100 | 310 | 60 | 235 | 200 |

Installation can only be carried out by an authorized person and according to the mounting instructions. Any other installation is considered to be improper. Make sure that the luminaire is always disconnected from the power supply before the installation work. Do not use the luminaire if damaged or if damaged the power cable. Technical changes are subjected without notice. Do not dispose the luminaire or its parts as household waste, but make the proper recycling.

### For wall mounting

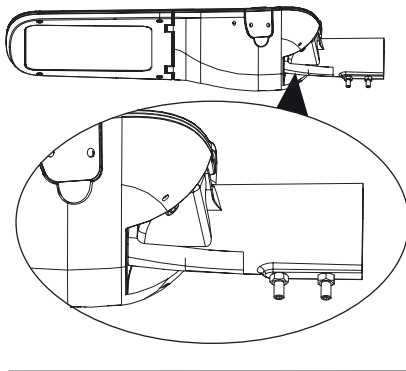

### Setting for pole top mounting

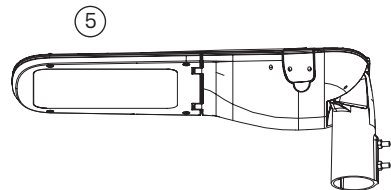
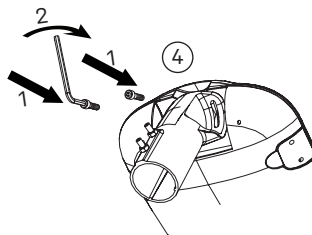
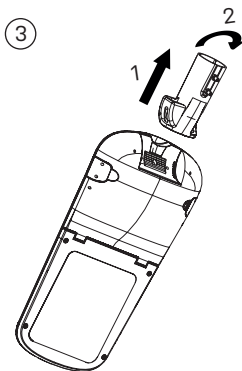
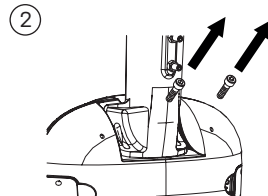
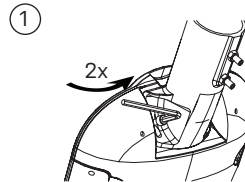

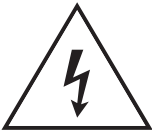

**IP66** 220-240V 50/60Hz

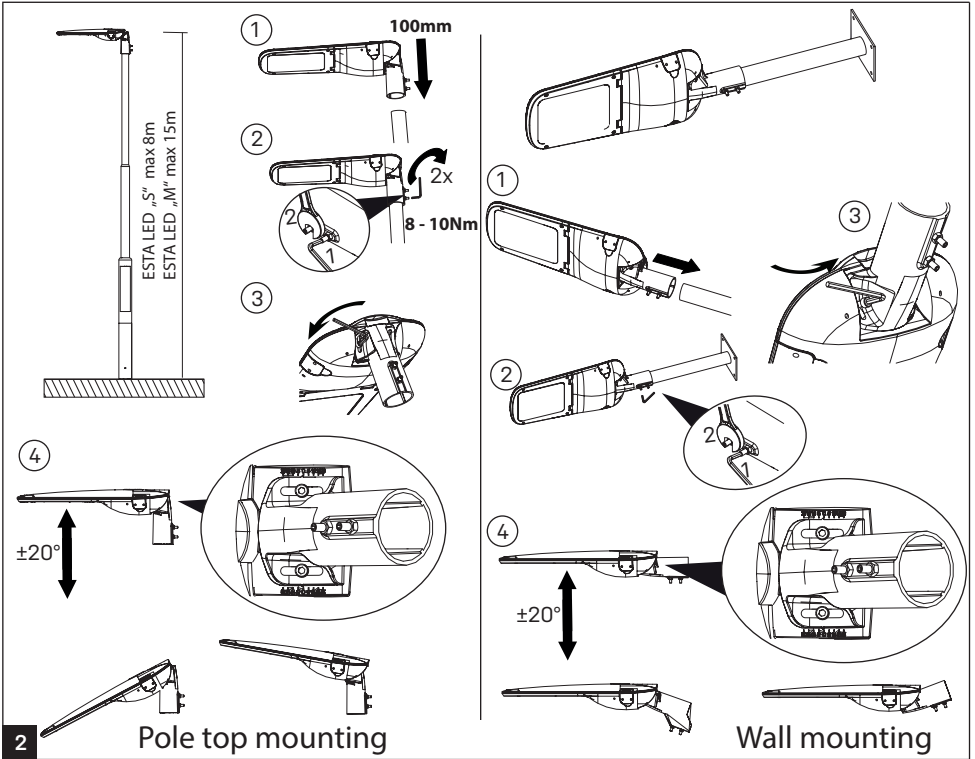

**A**

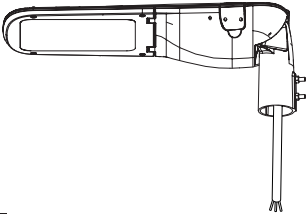

**3**

**B**

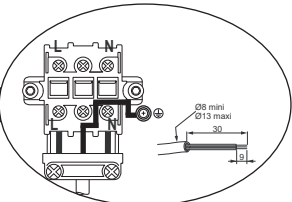
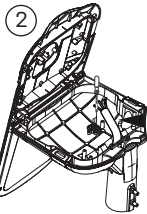
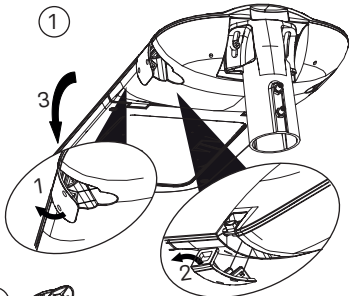

The light source in this luminaire may be replaced only by the manufacturer or its contractual service technician or similarly qualified person!

| Table of maximal numbers of ESTA LED luminaires in one line ON/OFF - DALI |             |       |              |              |              |              |              |              |              |              |              |              |
|---|-------------|-------|--------------|--------------|--------------|--------------|--------------|--------------|--------------|--------------|--------------|--------------|
| Body size   | 3000K/4000K |       | 10AB         | 16AB         | 20AB         | 25AB         | 10AC         | 16AC         | 20AC         | 25AC         |              |              |
|   |             |       | Σ luminaires | Σ luminaires | Σ luminaires | Σ luminaires | Σ luminaires | Σ luminaires | Σ luminaires | Σ luminaires | Σ luminaires | Σ luminaires |
| S   | 16/35       |       | 17           | 28           | 35           | 43           | 29           | 47           | 58           | 73           |              |              |
| S   | 24/35       | 24/70 | 7            | 12           | 15           | 18           | 12           | 20           | 25           | 31           |              |              |
| M   | 32/35       |       | 7            | 12           | 15           | 18           | 12           | 20           | 25           | 31           |              |              |
| M   | 48/35       | 48/70 | 6            | 11           | 13           | 17           | 11           | 18           | 23           | 29           |              |              |

| Table of maximal numbers of ESTA LED luminaires in one line SNS |             |       |              |              |              |              |              |              |              |              |              |              |
|---|-------------|-------|--------------|--------------|--------------|--------------|--------------|--------------|--------------|--------------|--------------|--------------|
| Body size   | 3000K/4000K |       | 10AB         | 16AB         | 20AB         | 25AB         | 10AC         | 16AC         | 20AC         | 25AC         |              |              |
|   |             |       | Σ luminaires | Σ luminaires | Σ luminaires | Σ luminaires | Σ luminaires | Σ luminaires | Σ luminaires | Σ luminaires | Σ luminaires | Σ luminaires |
| S   | 16/35       |       | 10           | 16           | 20           | 24           | 16           | 26           | 33           | 42           |              |              |
| S   | 24/35       | 24/70 | 10           | 16           | 20           | 24           | 16           | 26           | 33           | 42           |              |              |
| M   | 32/35       | 48/35 | 6            | 10           | 13           | 15           | 10           | 16           | 21           | 26           |              |              |
| M   |             | 48/70 | 3            | 5            | 6            | 7            | 5            | 8            | 10           | 13           |              |              |